

A

B

C

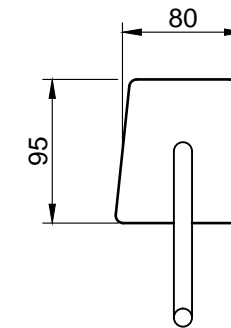
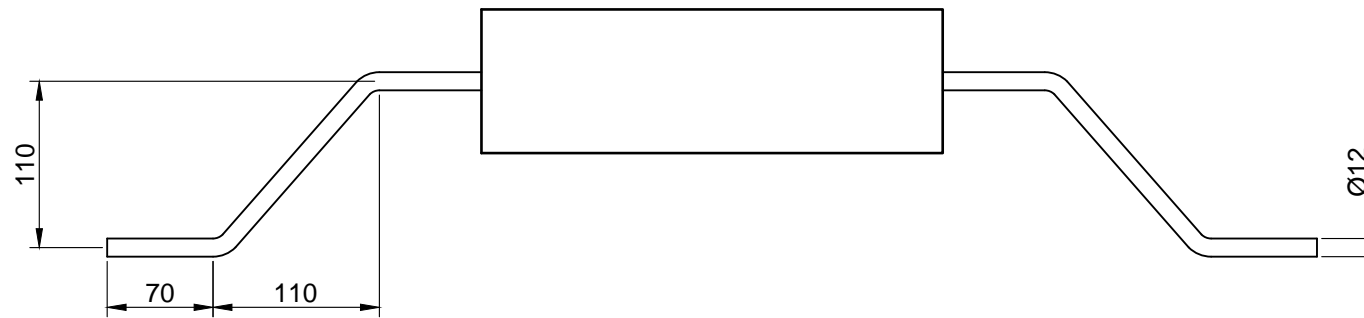
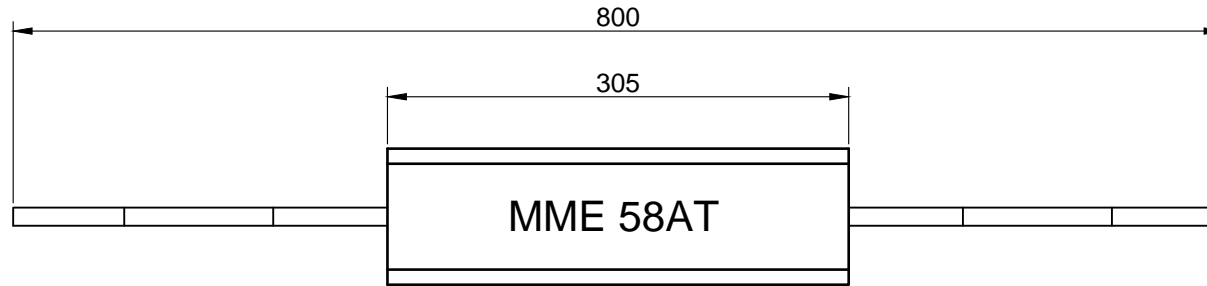

Aluminium alloy specification

Components	Impurities	Percentage (%)
Silicon		0.05 - 0.20
Zinc		3.50 - 5.00
Titanium		0.01 - 0.05
Bismuth		0.05 - 0.15
Indium		0.02 - 0.05
Aluminium		Remainder
	Copper	0.01 max
	Iron	0.15 max
	Others each	0.02 max
	Others total	0.05 max

Electrochemical capacity: 2700 Ahr / Kg nominal

Solution potential: -1100 mV vs. Ag / AgCl reference cell nominal (in seawater)

Other specifications are available on request.

Note: All dimensions and weights are nominal. Dimensions in mm
 All data is subject to change without prior notice
 Tank anodes available with Z-cranked (shown) or straight insert
 Other insert arrangements on request
 Anode can also be provided backside coated

Nett Weight: 5.8 Kg

Gross Weight: 6.6 Kg

Date:			Cathodic Protection Division Rietdekkerstraat 16 P.O. Box 4222 2980 GE Ridderkerk Netherlands Tel: +31 (0)180 48 28 28 E-mail: sales@mme.nl www.mme-group.com		Projection: 
			Order number:		Aluminium Alloy Tank Anode MME 58AT
Description:	Drawn: PdG	Date: 31-07-13	Project:		Sheet 1/1
	Checked: JdR	Date: 31-07-13	Dwg: MME 58AT		
Rev.	Approved: PM	Date: 31-07-13	Copyright MME. No part of this drawing may be copied, disclosed, or made public, in any form, without prior written consent of Materiaal Metingen Europe.		

A

B

C